

### Lateral Stiffener Bar

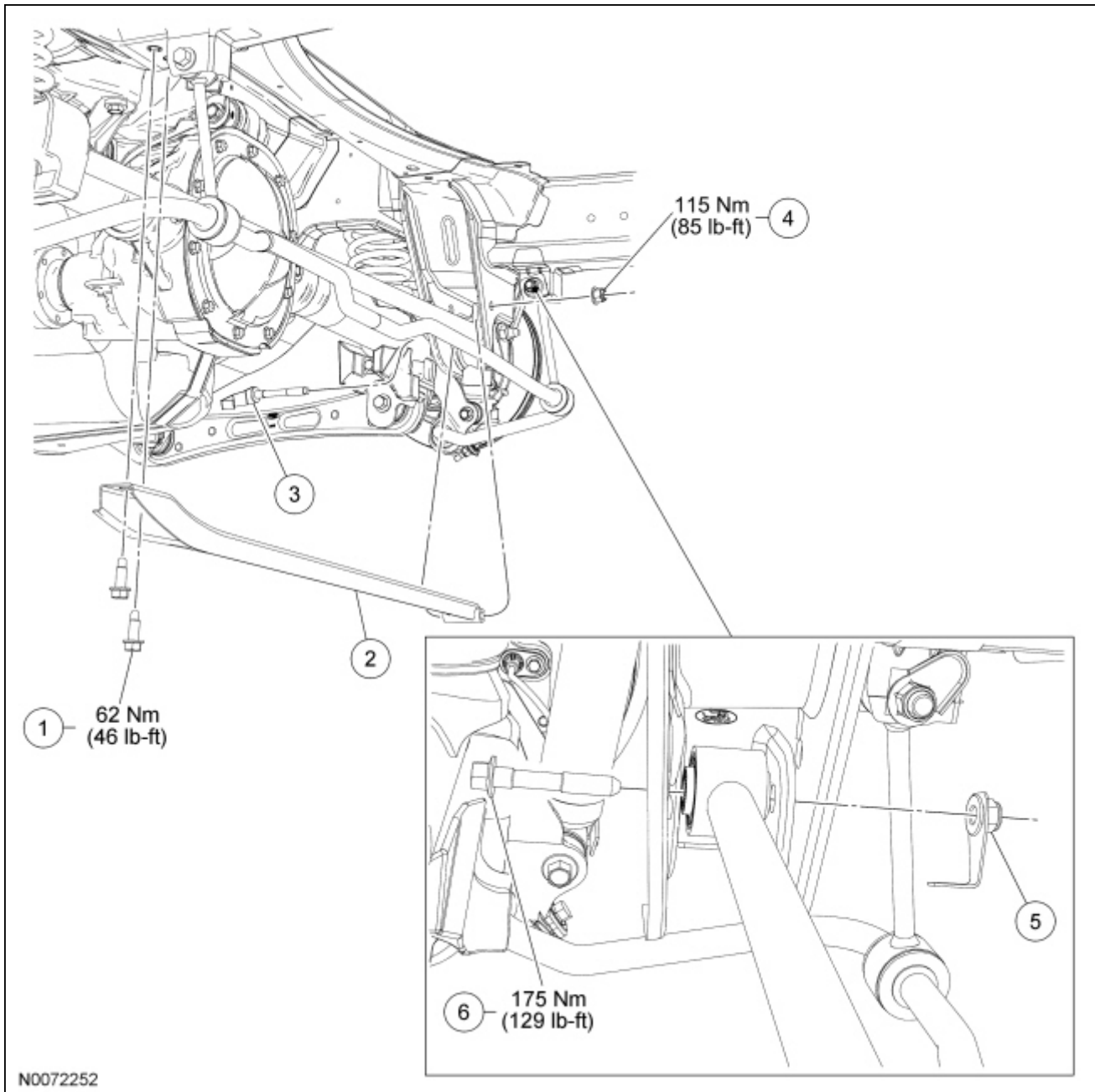

N0072252

Item	Part Number	Description
1	W711331	Lateral stiffener bar-to-body bolt (2 required)
2	3424	Lateral stiffener bar
3	W710693	Lateral stiffener bar flag bolt
4	W520214	Lateral stiffener bar nut
5	W710022	Panhard rod flagnut (RH)
6	W704886	Panhard rod bolt

## Removal and Installation

**NOTICE:** Suspension fasteners are critical parts because they affect performance of vital components and systems and their failure may result in major service expense. New parts must be installed with the same part numbers or equivalent part, if replacement is necessary. Do not use a replacement part of lesser quality or substitute design. Torque values must be used as specified during reassembly to make sure of correct retention of these parts.

1. Mark the rear shock absorber relative to the protective sleeve with the vehicle in a static, level ground position (curb height).

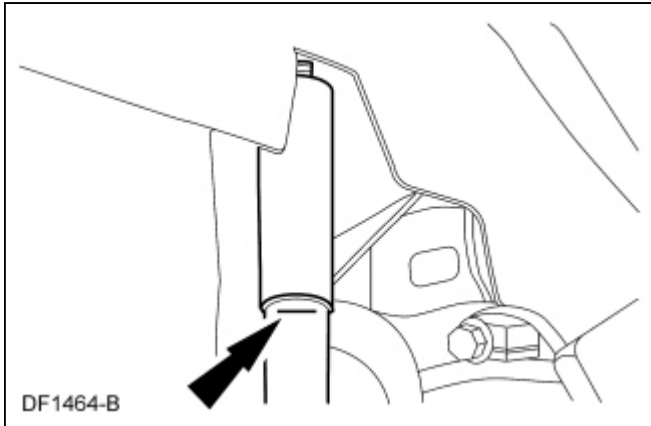

2. With the vehicle in NEUTRAL, position it on a hoist. For additional information, refer to [Section 100-02](#).
3. **NOTICE:** Do not support the rear axle at the differential housing or damage to the housing may occur.

Using 2 suitable jackstands, support the rear axle.

4. Raise the rear axle so the mark made on the rear shock absorber in Step 1 lines up with the protective sleeve.

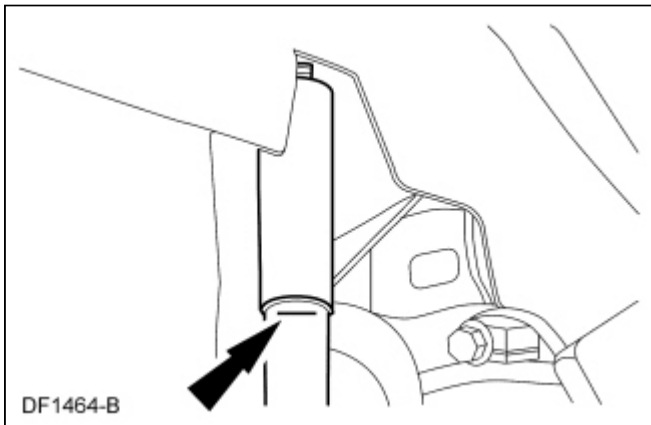

5. Remove and discard the RH panhard rod bolt, then remove and discard the lateral stiffener bar-to-body mount nut and flag bolt.
  - To install:
    - Tighten the new RH panhard rod bolt to 175 Nm (129 lb-ft).
    - Tighten the new lateral stiffener bar-to-body mount nut to 115 Nm (85 lb-ft).

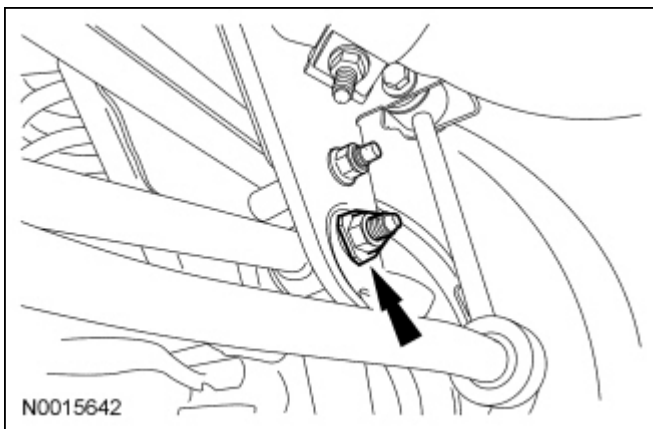

6. Remove and discard the lateral stiffener bar-to-body bolts.
  - To install, tighten the new bolts to 62 Nm (46 lb-ft).
7. Remove the lateral stiffener bar.
8. **NOTICE:** Tighten the new RH panhard rod bolt while the suspension is at curb height or bushing damage and incorrect clamp load may occur.

To install, reverse the removal procedure.

---